

Instructions - System solution
 PIR/MIWO - Type A
 Insulating panel type M/FV

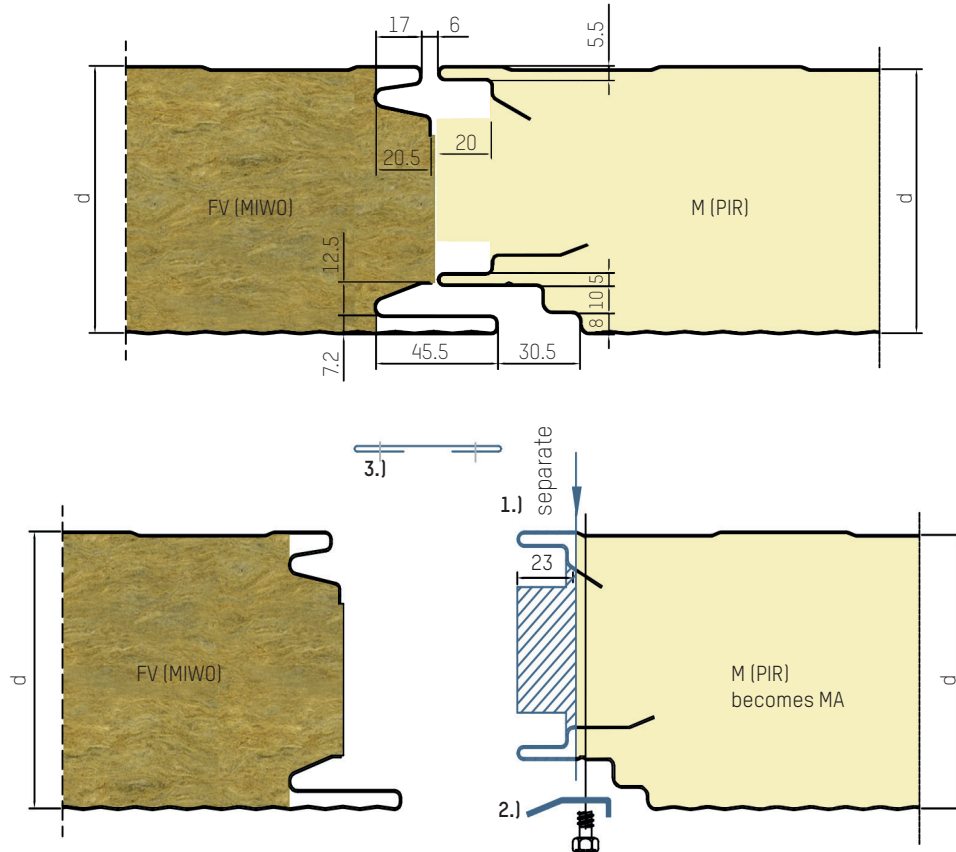

Work steps:

- 1.) Cut off the PIR panel.
- 2.) Fasten the PIR panel with mounting strap „A“ without sealing washer item no. 1003884 to the base construction and slide the MIWO panel in. Distance of the mounting strap approx. 1000mm. Stick sealing tape under mounting straps.
- 3.) Install the flat section item no. 1000979 on the inner surface.

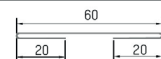

Example: MA100/FV100, PIR/MIWO

