

Note:

Apply sealing compound to the side joints under the sealing tape at the sandwich panel end supports/cross edges.

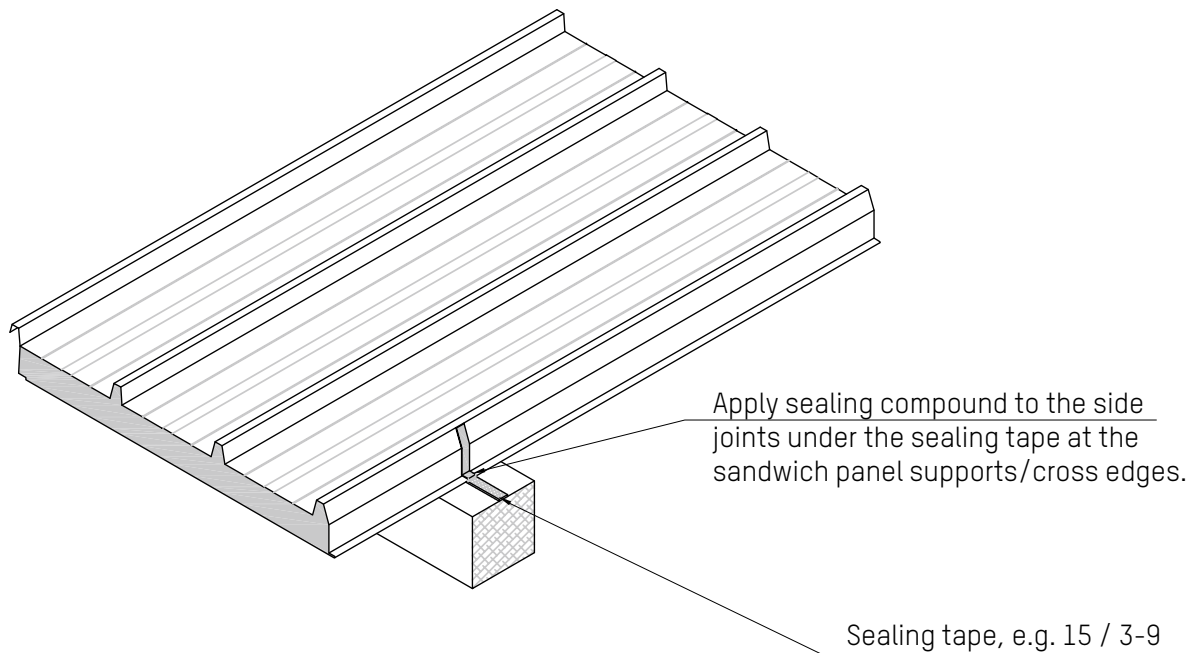

Sandwich panel roof

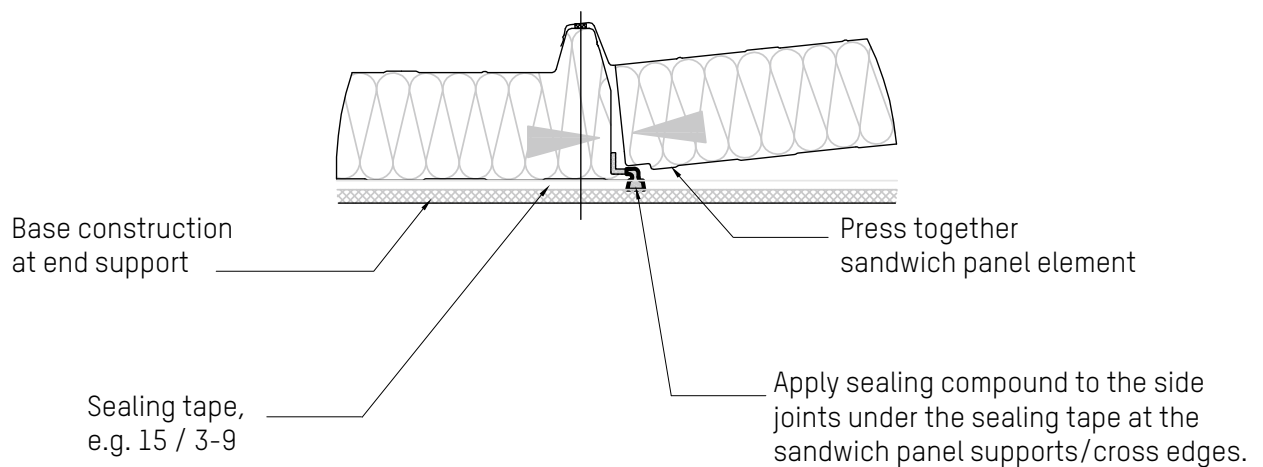

Roof panel - Fire safety, sound dampening and thermal insulation

Side joints

FD 300.1

As of: 05/21

Note:

Fasten using fasteners with a sealing washer $\varnothing \geq 19\text{mm}$. Alternatively, fastening on the upper edge is possible using a screw with a sealing washer $\varnothing 16\text{mm}$ or 19mm and storm washer. The number and arrangement must comply with the requirements of the static calculation! Connectors with thread under the head (undercut) have proven reliability for fastening the lower edge with fasteners and a sealing washer $\varnothing \geq 19\text{mm}$.

Fix the side lap into place using fasteners with sealing washers $\varnothing \geq 14\text{mm}$.

The roof slope must be at least 3° (= 5%) or, if using end laps, observe the instructions given in the detailed construction document: "End lap" FD 303-1.

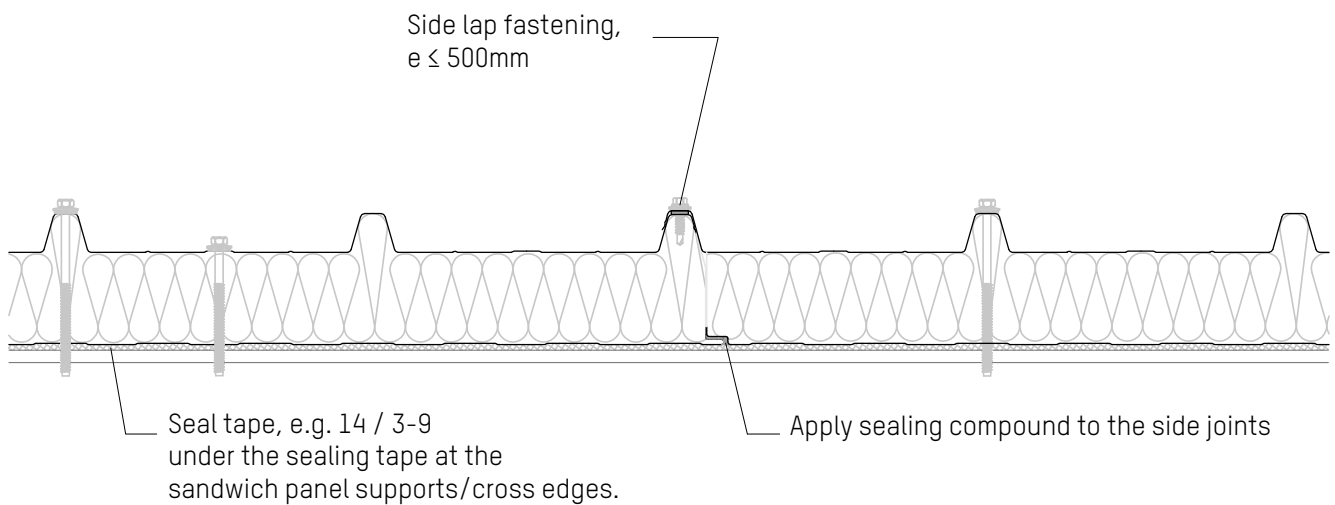

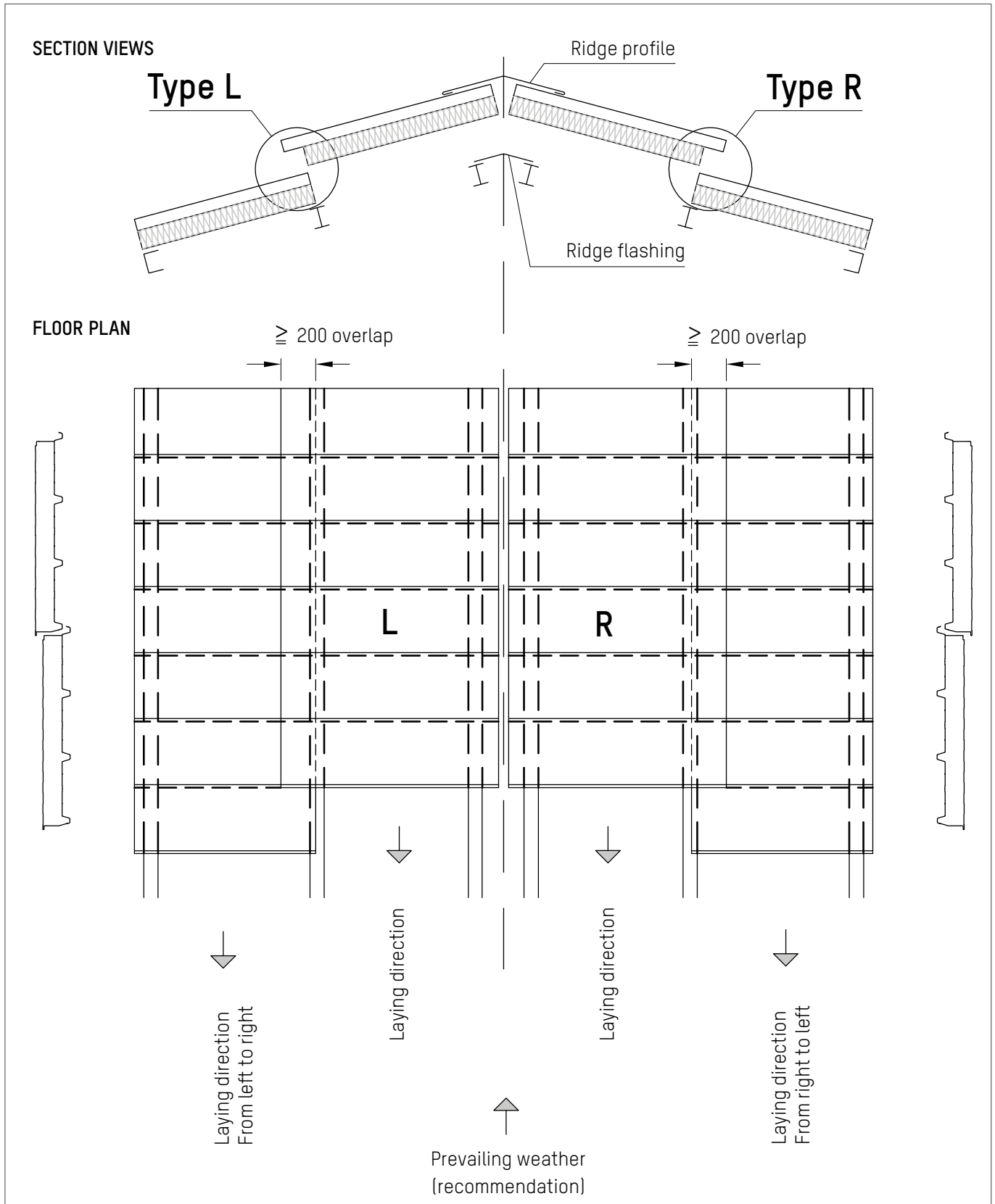

Roof panel - Fire safety, sound dampening and thermal insulation

Side and end lap

D 302.1

As of: 05/21

Note:

ROMAplast may be used to apply additional sealing in the overlap area.

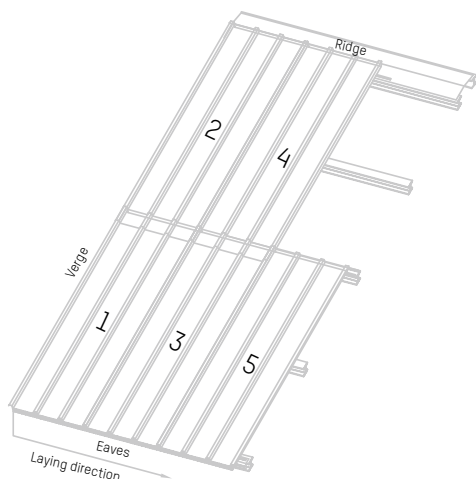
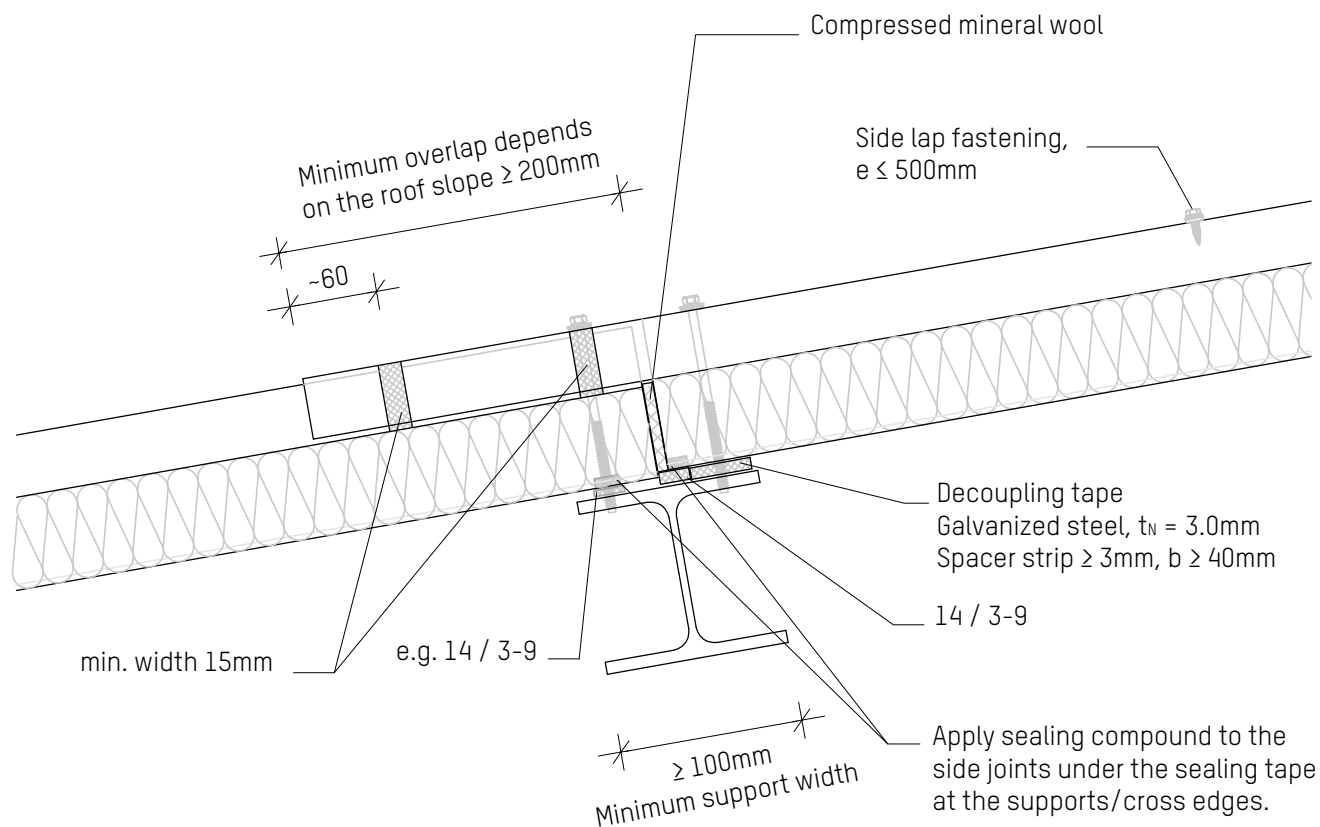

Roof pitch in degrees	Overlap in mm
3 (minimum roof pitch) up to 5	Without end lap and without penetration
5 to 7	200 with additional measures
7 (standard roof pitch)	200
≥ 7	200
≥ 12	150
≥ 20	100

Roof panel - Fire safety, sound dampening and thermal insulation

End lap

D 303.1

As of: 05/21

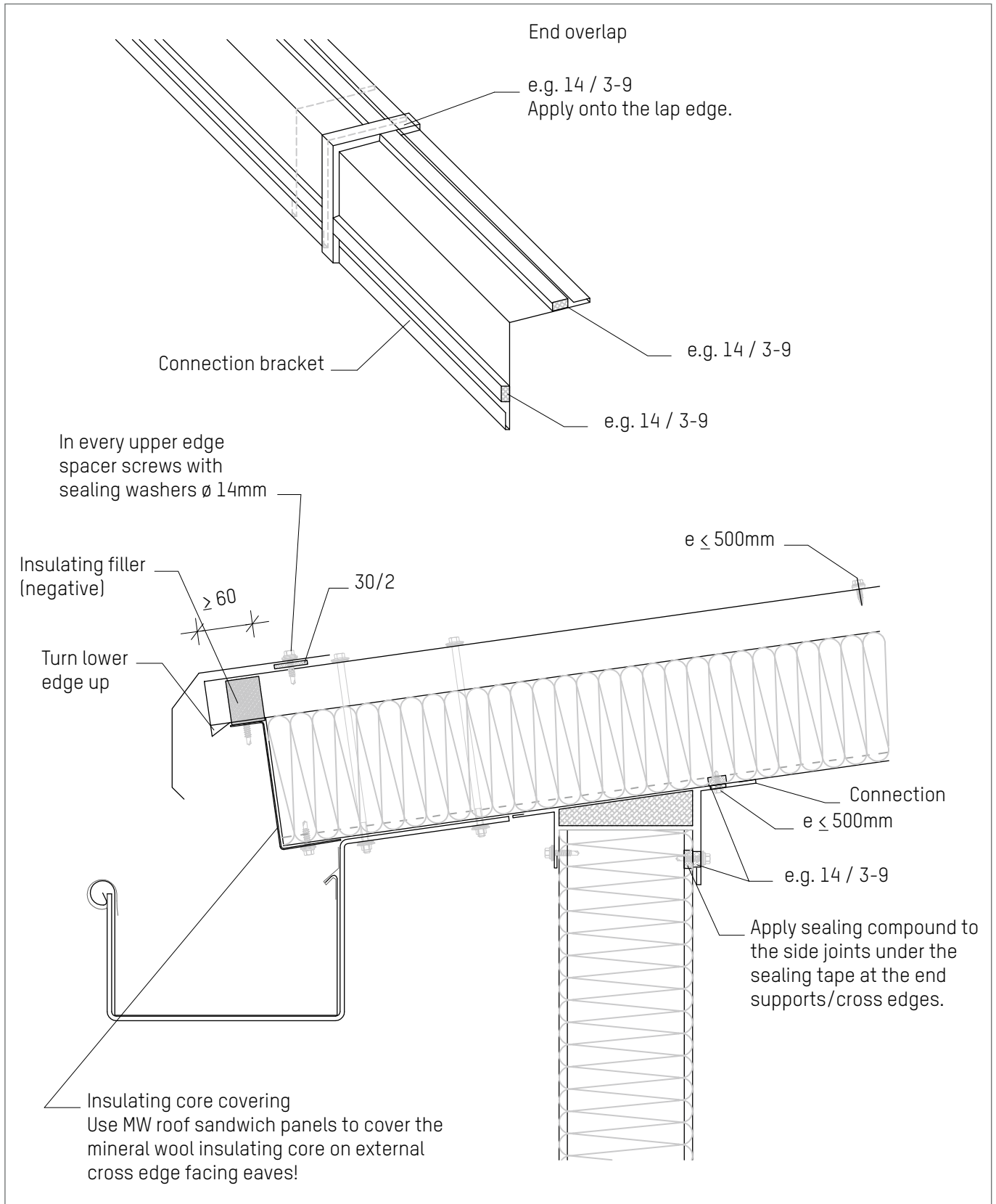

Roof panel - Fire safety, sound dampening and thermal insulation

Eaves variant 2

D 304.1

As of: 05/21

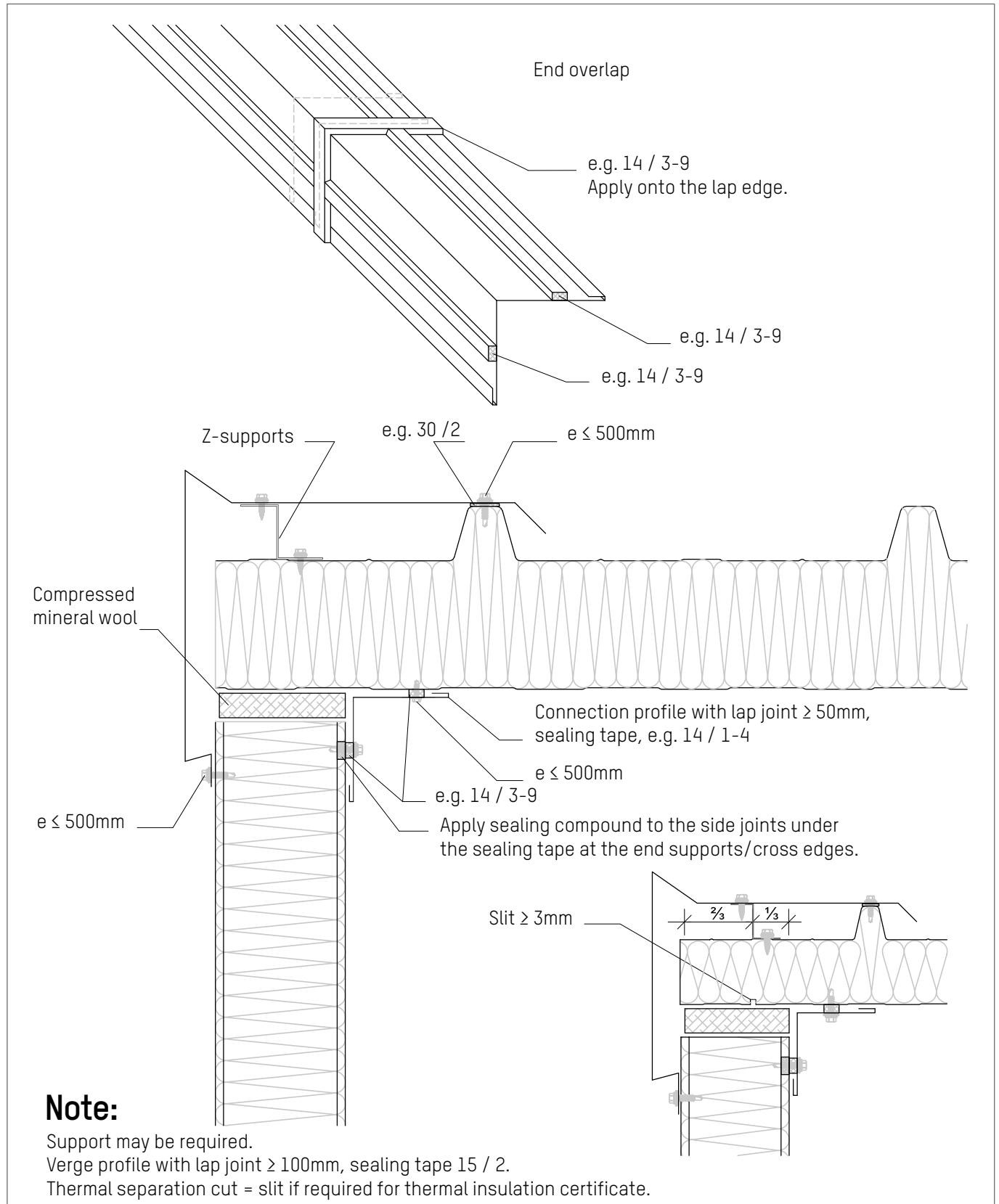

Roof panel - Fire safety, sound dampening and thermal insulation

Verge variant 2

D 305.1

As of: 07/21

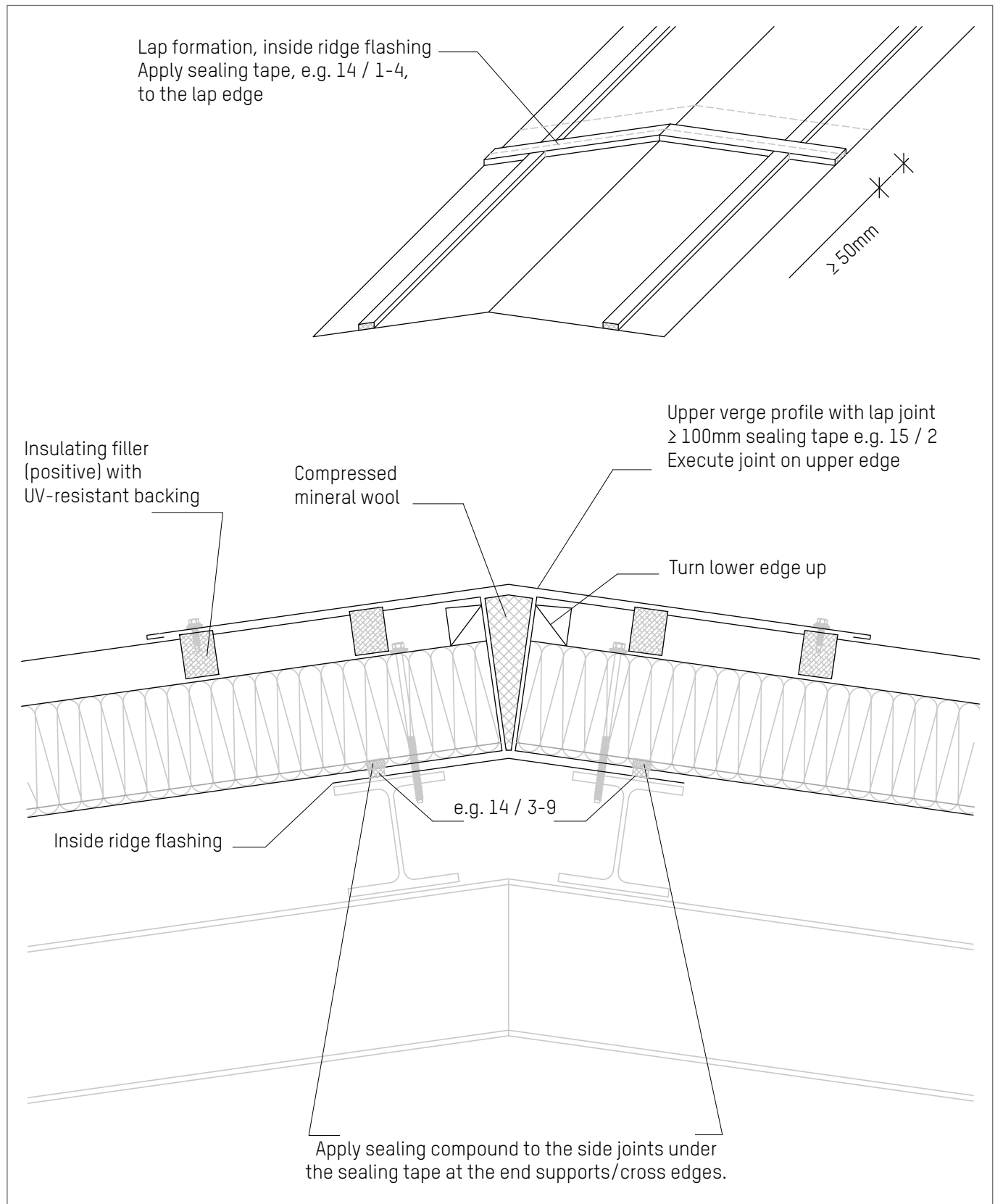

Roof panel - Fire safety, sound dampening and thermal insulation

Ridge variant 1

D 306.1

As of: 05/21

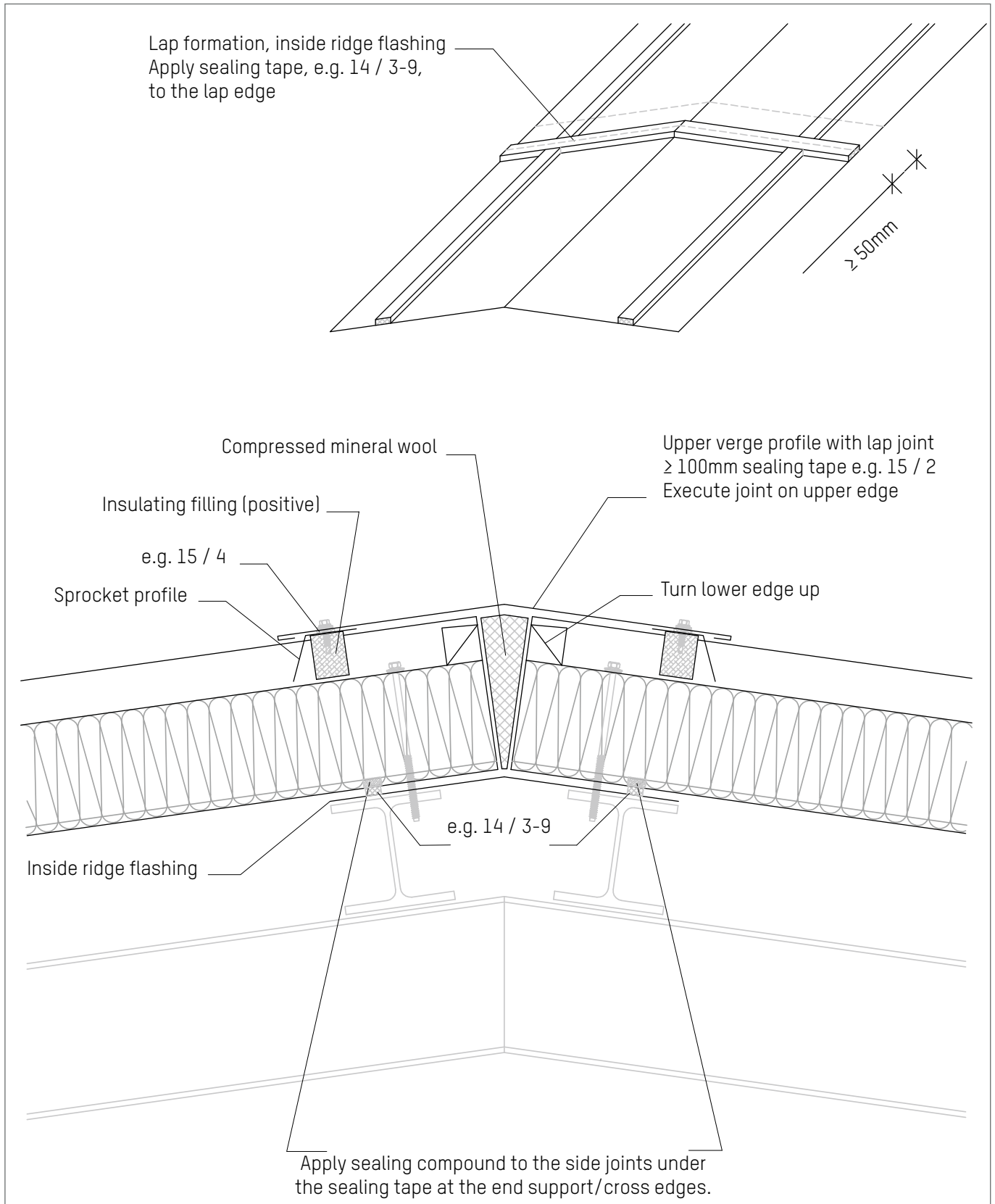

Roof panel - Fire safety, sound dampening and thermal insulation

Ridge variant 2

D 307.1

As of: 05/21

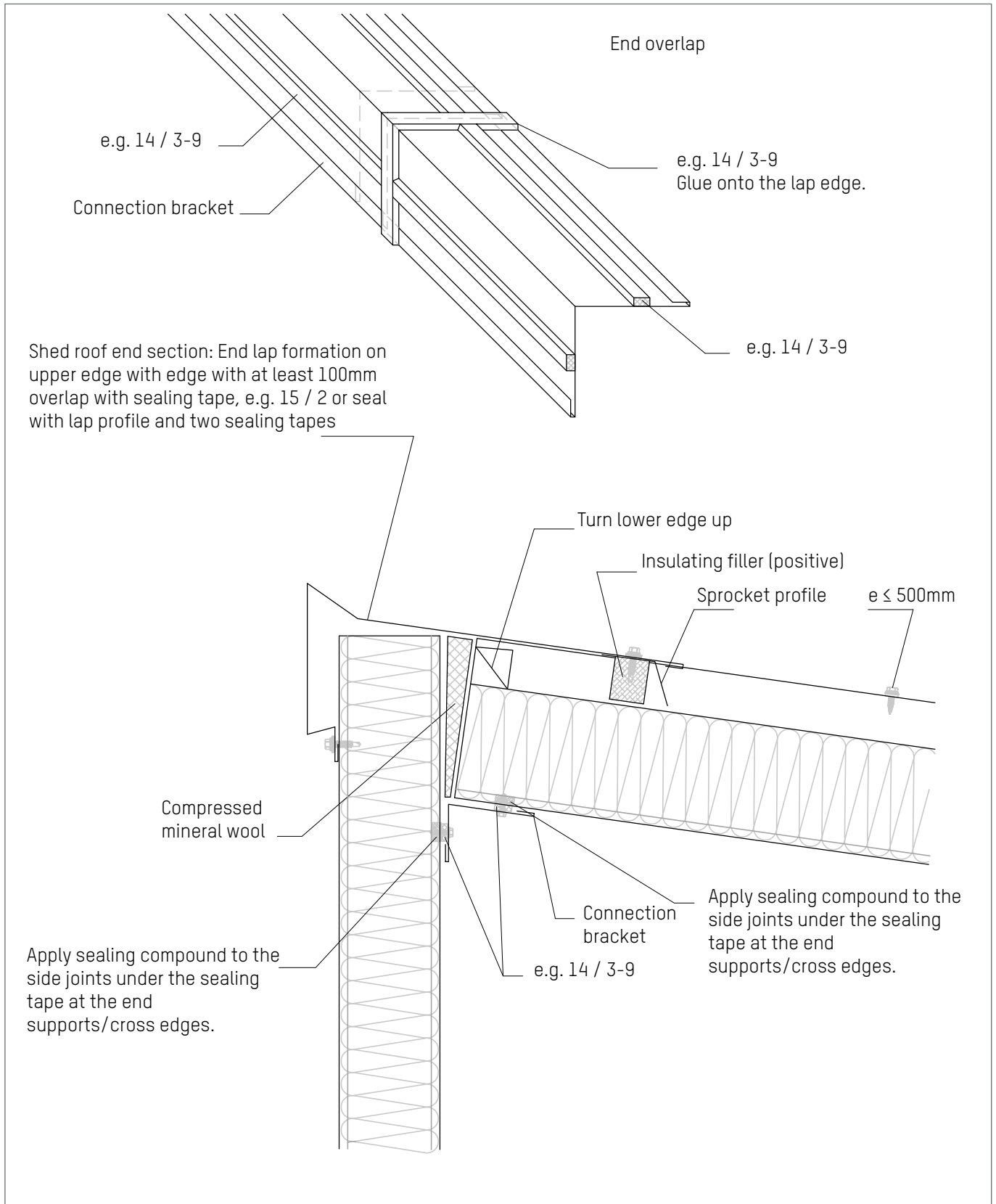

Roof panel - Fire safety, sound dampening and thermal insulation

Shed roof variant 1

D 308.1

As of: 07/21

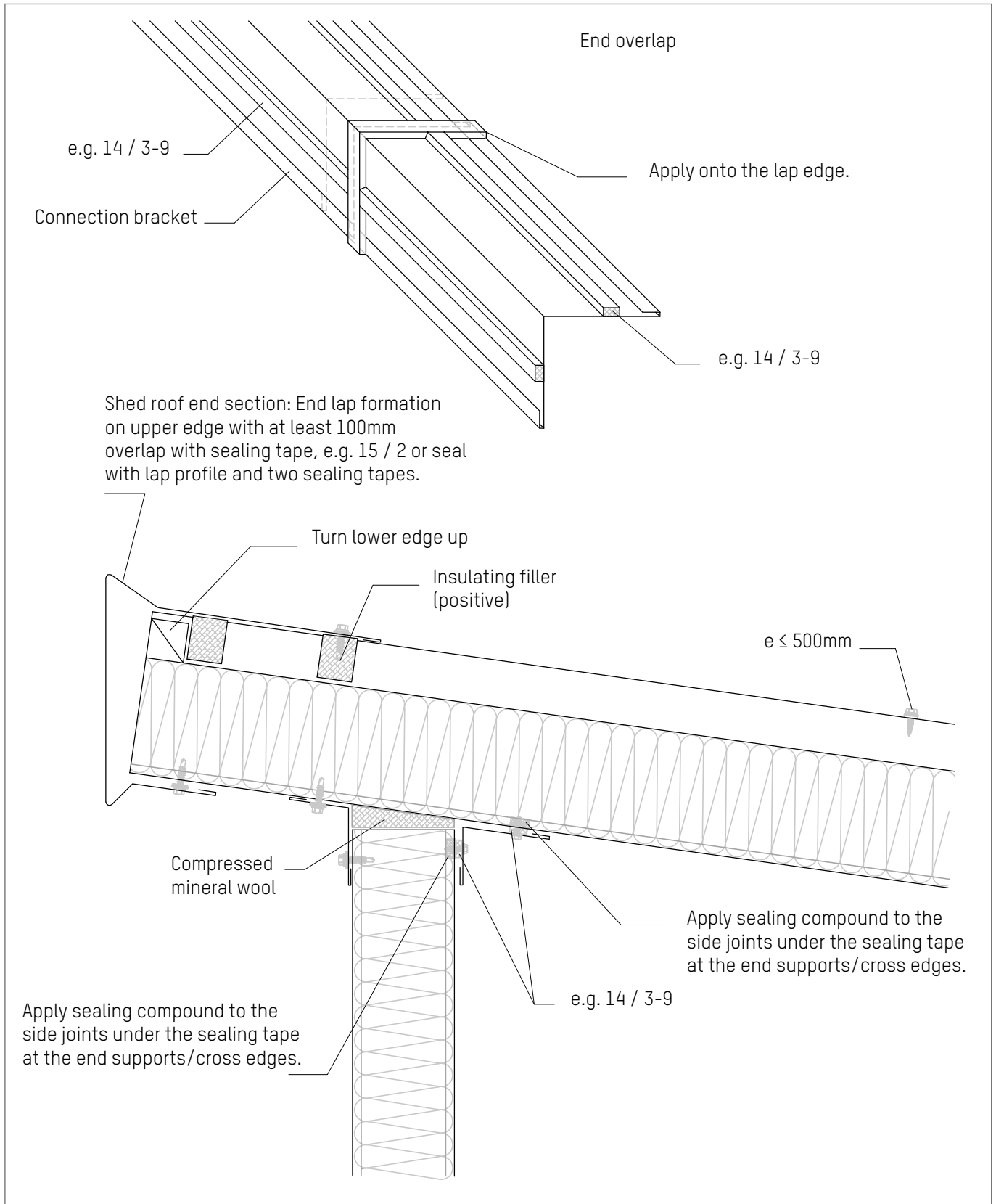

Roof panel - Fire safety, sound dampening and thermal insulation

Shed roof variant 2

D 309.1

As of: 07/21