

Quick-assembly insulating panel, type FV

for high-quality exclusive panel construction

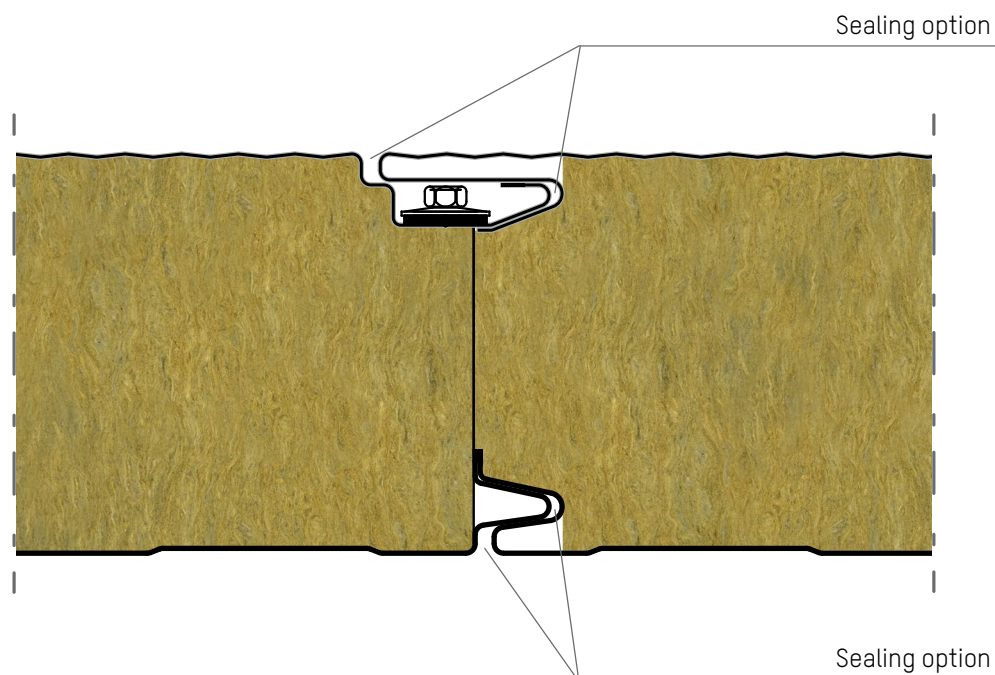

- Exclusive facade with hidden joints
- 4 different surface profile variants
- Available in two different volume weights, as required per application
- Quick and easy assembly
- Vertical or horizontal assembly possible
- Module width 1.000 mm
- Insulation thicknesses 60, 80, 100, 120, 140, 150, 170, 200, 240 mm

Quick-assembly insulating panel, type FV with external and internal steel cladding

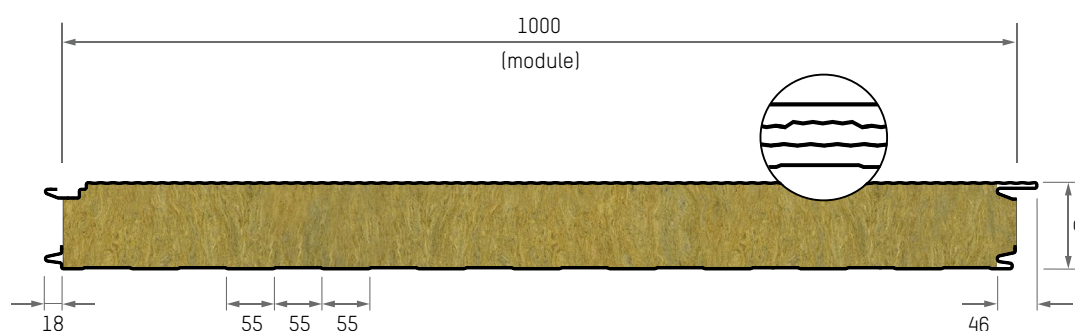

Cladding layers	Coil galvanized and coated sheet steel with organic coating materials, further cladding layers are available on request
Surface finishes	
Standard:	External face: microlined (14 mm), Internal face: profiled (55 mm)
Optional:	External face: profiled (55 mm), w-profiled (55/14 mm) or smooth, internal face: smooth
Insulating core	Mineral wool, fiber-adjusted, water-repellent and non-flammable A1 Density FV eco: 90 kg/m ³ , FV: 120 kg/m ³
Fire tests	Ⓔ Euro class A2-s1, d0 in accordance with EN 13501-1
Fire resistance	Notification of approval Z-19.52-2187 of the DIBt Berlin FV100-EI 60/E 120 (horizontal, 0.6/0.6); FV120-EI 90 (vertical, 0.6/0.6) in accordance with EN 13501-2
Approval	Notification of approval ABg Z-10.49-836 resp. ABg Z-10.49-837 of the DIBt Berlin in accordance with DIN EN 14509 (CE marking)
Available lengths	Up to 16 m, depending on panel thickness
Production tolerances	In accordance with DIN EN 14509
Sound insulation	FV eco approx. 31 dB and FV approx. 32 dB for all panel thicknesses
Statics	See our span tables

Panel type		FV060	FV080	FV100	FV120	FV140	FV150	FV170	FV200	FV240
Density	kg/m ³	120								
Panel thickness	mm	60	80	100	120	140	150	170	200	240
Cladding layer thickness										
External	mm	0.6	0.6	0.6	0.6	0.6	0.6	0.6	0.6	0.6
Internal	mm	0.5	0.5	0.5	0.5	0.5	0.5	0.5	0.5	0.5
Panel weight approx.	kg/m ²	16.8	19.2	21.6	24.0	26.4	27.4	30.0	33.6	38.4
U-value acc. to EN 14509 with joint	W/(m ² ·K)	0.861	0.585	0.459	0.380	0.325	0.303	0.267	0.227	0.190
Panel type			FV eco 080	FV eco 100	FV eco 120	FV eco 140	FV eco 150	FV eco 170	FV eco 200	FV eco 240
Density	kg/m ³		90							
Panel weight approx.	kg/m ²		16.8	18.6	20.4	22.2	23.1	24.9	27.6	31.2
U-value acc. to EN 14509 with joint	W/(m ² ·K)		0.513	0.402	0.332	0.284	0.265	0.233	0.197	0.165