

Quick-assembly MW roof panel, type FD

High quality thermal insulation system for safe and rapid roofing with higher fire protection requirements

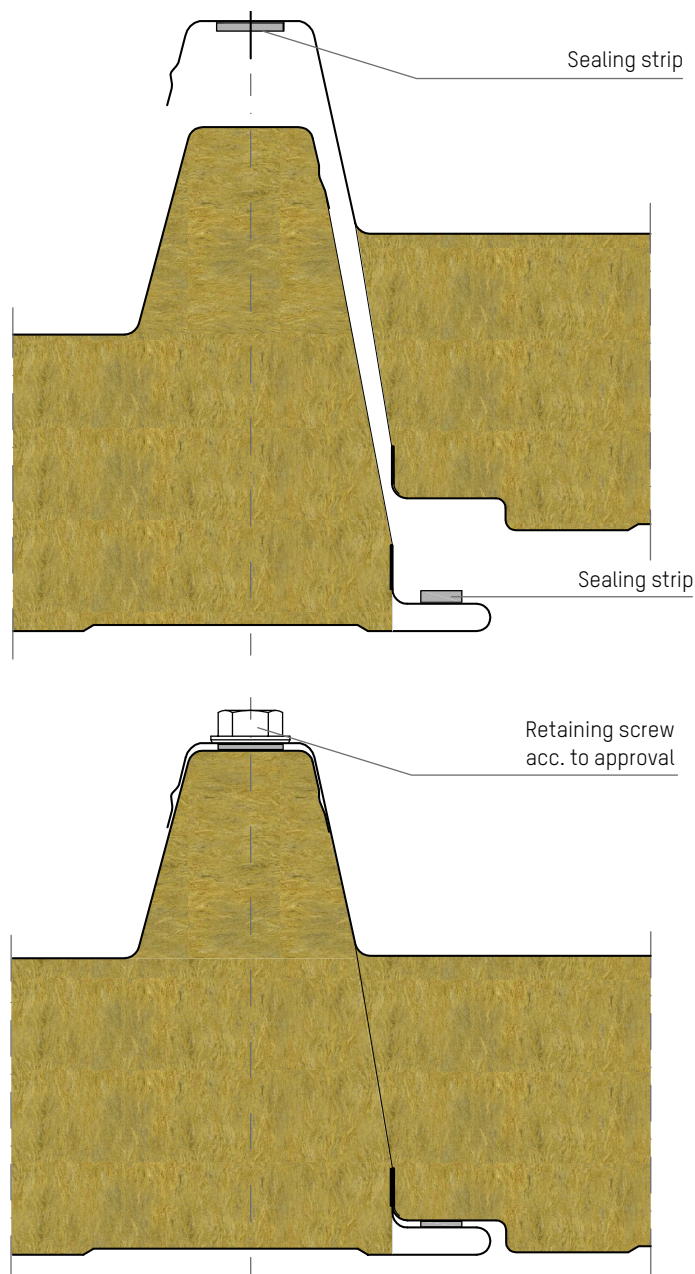

- Mineral wool insulating core with two different volume weights
- quick and easy assembly
- The same joint geometry as the type D PIR panel
- Width of module 1000mm
- Insulation thickness (without beads) 60, 80, 100, 120, 140, 150, 170, 200, 240mm
- recommended roof pitch min. 5% ($\pm 3^\circ$)

Quick-assembly MW roof panel, type FD with steel cladding on both sides

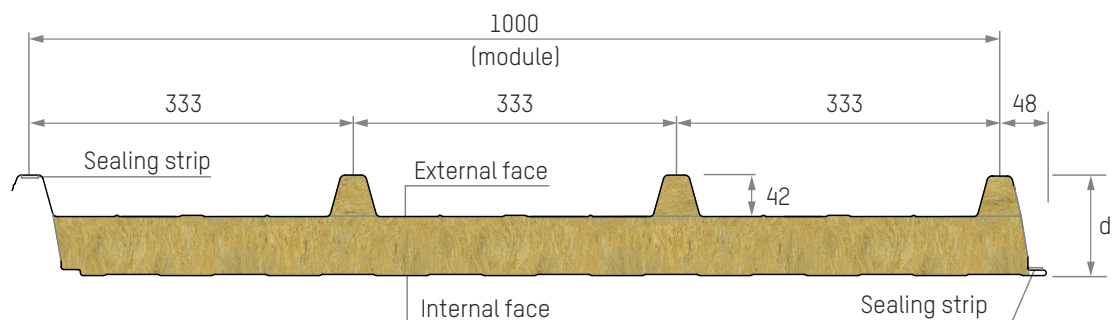

Cladding layers	Coil galvanized and coated sheet steel with organic coating materials, further cladding layers are available on request
Surface finishes	Standard: external face trapezoidal profile (333mm), internal face profiled (56mm)
Insulating core	Mineral fiber, non-flammable (A1), fiber-adjusted, water-repellent
Fire tests	Ⓔ Euro-Class A2-s1, d0 according to EN 13501-1
Fire resistance* acc. to classification report	FD142 (and thicker) REI 90 / RE 120 according to EN 13501-2
Fire resistance D	FD142 (and thicker) REI 90 according to EN 13501-2
Approval	ABg Z-10.49-836/1 resp. -837/1
System dimensions	Element width 1.068mm; module width 1.000mm
Available length	Up to 15m, depending on panel thickness
Production tolerances	In accordance with EN 14509
Sound insulation	Type FD eco 30dB / Type FD 32dB from thickness 60mm
Statics	pending

Panel type		FD102	FD122	FD142	FD162	FD182	FD192	FD212	FD242	FD282
Density	kg/m ³	120								
Panel thickness	mm	102	122	142	162	182	192	212	242	282
Insulating thickness (without bead)	mm	60	80	100	120	140	150	170	200	240
Cladding layer thicknesses										
External	mm	0.6	0.6	0.6	0.6	0.6	0.6	0.6	0.6	0.6
Internal	mm	0.5	0.5	0.5	0.5	0.5	0.5	0.5	0.5	0.5
Panel weight approx.	kg/m ²	18.3	20.7	23.1	25.5	27.9	28.6	31.5	35.1	39.9
U value in accordance with EN 14509 with joint	W/(m ² ·K)	0.699	0.534	0.432	0.363	0.313	0.292	0.259	0.221	0.185
Panel type		FD eco 102	FD eco 122	FD eco 142	FD eco 162	FD eco 182	FD eco 192	FD eco 212	FD eco 242	FD eco 282
Density	kg/m ³	90								
Panel weight approx.	kg/m ²	16.4	18.2	20.0	21.8	23.6	24.0	26.3	29.0	33.6
U value in accordance with EN 14509 with joint	W/(m ² ·K)	0.615	0.468	0.378	0.317	0.273	0.255	0.226	0.192	0.161

* No application approval for Germany (D)