

ROMA INSULATION SYSTEMS

Fire safety, sound dampening and thermal insulation

Type FD quick-assembly insulating panel

SO EVERYTHING FITS. **ROMA**

ROMA quick-assembly roof panel

Type FD and type FD+



| | |
|-----------------------|--|
| Cladding layers | Coil galvanized sheet steel with organic plastic coating, further cladding layers are available on request |
| Surface finishes | Standard: External face trapezoidal profile (333.3mm), internal face profiled (58mm) |
| Insulating core | Mineral fiber, non-flammable (A1), fiber-adjusted, water-repellent |
| Density | Panel FD: 100 kg/m ³ ; FD+: 135 kg/m ³ |
| Fire tests | Euro class A2-s1, d0 |
| Fire resistance | pending |
| Fire resistance D | pending |
| Approval | CE marking in accordance with EN 14509 |
| System dimensions | Element width 1.068mm; module width 1.000mm |
| Available lengths | Up to 15m, depending on panel thickness |
| Production tolerances | In accordance with EN 14509 |
| Sound insulation | Approx. 30dB for all panel thicknesses |
| Statics | pending |

How you benefit:

- The same joint geometry as the type D PIR panel
- Insulation and roof cladding in one construction element
- Precisely fitted connection without the formation of thermal bridges
- Immediately walkable and self-supporting
- Laying not affected by weather conditions
- Rapid and easy installation
- Cladding layers with protective foil for transport and installation
- On request, delivery free construction site
- Bundling of elements as required

Optimal fire protection – now for your roof, too

The ROMA mineral wool type FD roof panel is a non-flammable sandwich element. It consists of two high-grade steel cladding layers and a mineral wool insulating core. This sandwich panel element is 1.000mm wide and comes in convenient lengths of up to 15m.

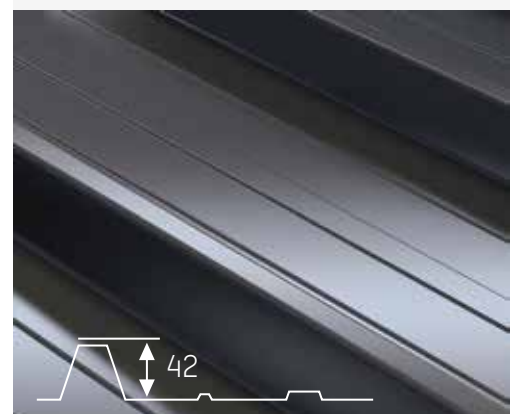

Installation and connection technology

Ease of installation – intelligent connections



Transition mineral wool/PIR panel

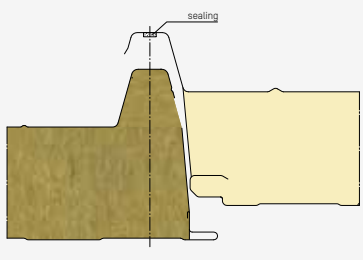

The type FD mineral wool roof panel is the ideal complement for the type D roof panel for fire areas that need to prevent flying sparks. The joint geometry of the two roof types is coordinated so that laying can be carried out quickly and easily. Together, the ROMA PIR and mineral wool roof panels allow economic and rapid construction that is energy efficient while taking demanding fire code requirements into consideration.

| Panel type | | FD102 | FD122 | FD142 | FD162 | FD182 | FD212 | FD242 | FD282 |
|--|-----------------------|--------|--------|--------|--------|--------|--------|--------|--------|
| Density | kg/m ³ | 100 | | | | | | | |
| Panel thickness | mm | 102 | 122 | 142 | 162 | 182 | 212 | 242 | 282 |
| Insulating thickness (without bead) | mm | 60 | 80 | 100 | 120 | 140 | 170 | 200 | 240 |
| Cladding layer thicknesses | External | 0.6 | 0.6 | 0.6 | 0.6 | 0.6 | 0.6 | 0.6 | 0.6 |
| | Internal | 0.5 | 0.5 | 0.5 | 0.5 | 0.5 | 0.5 | 0.5 | 0.5 |
| Panel weight approx. | kg/m ² | 16.6 | 18.6 | 20.6 | 22.6 | 24.6 | 27.6 | 30.6 | 34.6 |
| U value in accordance with EN 14509 with joint | W/(m ² ·K) | 0.658 | 0.501 | 0.405 | 0.340 | 0.293 | 0.242 | 0.207 | 0.173 |
| Panel type | | FD+102 | FD+122 | FD+142 | FD+162 | FD+182 | FD+212 | FD+242 | FD+282 |
| Density | kg/m ³ | 135 | | | | | | | |
| Panel weight approx. | kg/m ² | 18.8 | 21.5 | 24.2 | 26.9 | 29.6 | 33.7 | 37.7 | 43.1 |
| U value in accordance with EN 14509 with joint | W/(m ² ·K) | 0.713 | 0.544 | 0.441 | 0.370 | 0.319 | 0.265 | 0.226 | 0.189 |

This information is non-binding and prepared to the best of our knowledge while taking relevant standards and regulations into consideration. Drawings and pictures serve informational purposes only. All rights reserved. Reproduction in whole or in part only by consent of Romakowski GmbH & Co. KG, Bittenwiesen, Germany. Our General Business Conditions (AGB) also apply.

Design flexibility thanks to product variety

The play of light and shadow

The surface of the roof panel is lent visual flair by three large beads at 333 mm intervals and three small interspersed beads. This creates an appealing light and shadow effect.

Colors and coatings

Add vibrant colors to your roof with ROMA: Our system offers many different paints and coatings in standard and custom colors, including polyester

paint coatings and other coating systems. This means ROMA can supply roof panel types matching your specific technical requirements – while also offering attractive design options.

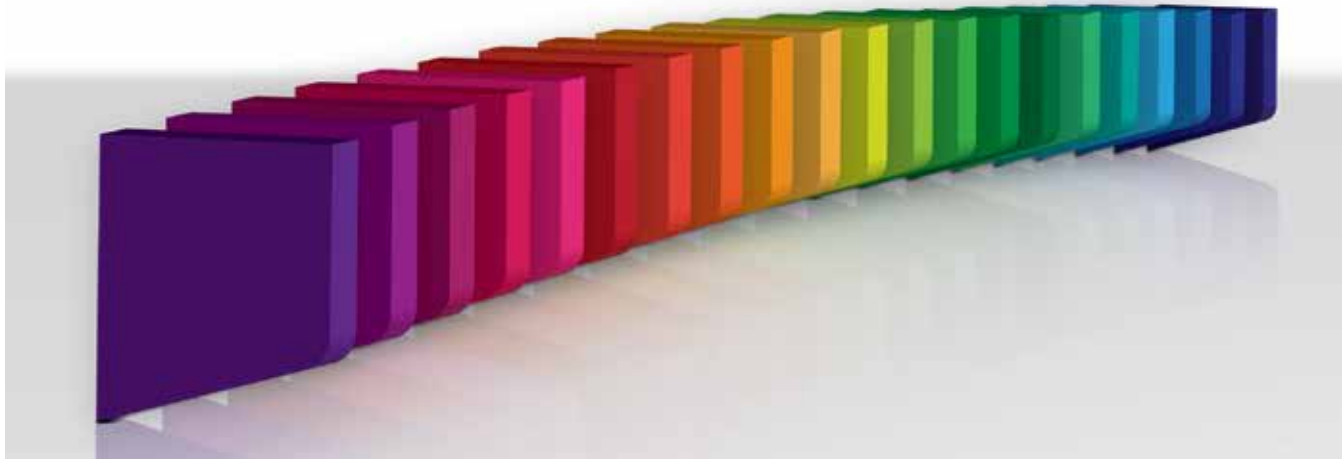

We offer you a wide range of attractive colors.

Please see our color chart for more information on cladding layers and color options.

Planning details

Please consult our current technical data sheets for more detailed information.

www.roma-daemmsysteme.de/downloads

ROMA. So everything fits.

ROMA is a leading manufacturer of wall- and roof-sandwich panels for industrial and cold-store construction.

We develop, manufacture and market complete construction systems for industrial structural engineering as well as cold-store and deep-freeze cell and cell door construction. Our range of products also includes climate chambers, cleanrooms and specialized rooms for a wide range of applications in the HVAC industry. We can look back on 70 years of success and experience in highly specialized construction sectors. Ever since its founding, our family-run business has always manufactured top-quality products Made in Germany.



Additional information about our products is available at:
www.roma-daemmsysteme.de

Romakowski GmbH & Co. KG
Herdweg 31
86647 Buttenwiesen, Germany
Phone +49 (0) 8274.999-0
Fax +49 (0) 8274.999-150
info@roma-daemmsysteme.de