

Order form - System solution Type C and Type D

PIR/MIWO - Type C

Insulating panel type PC/FP

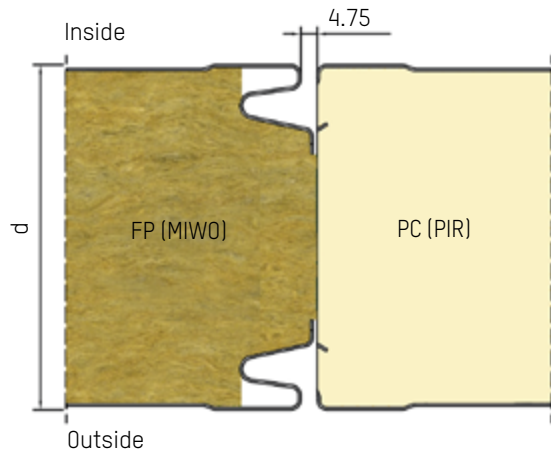

PIR panel type PC	
Thickness (mm)	
Amount	
Length (mm), max 10.000mm	
MIWO panel type FP	
Thickness (mm)	
Amount	
Length (mm), max 10.000mm	

MIWO/PIR - Type D

Insulating panel type FPD/P

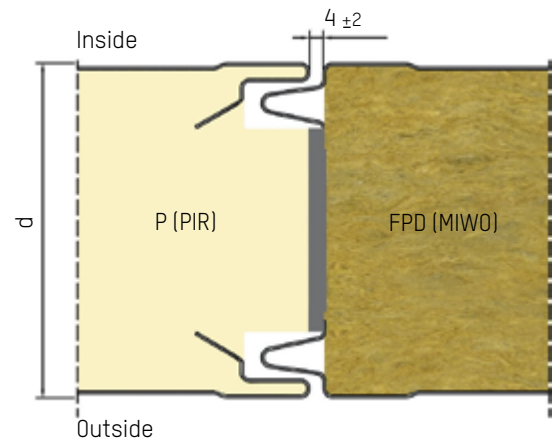

MIWO panel type FPD	
Thickness (mm)	
Amount	
Length (mm), max 10.000mm	
PIR panel type P	
Thickness (mm)	
Amount	
Length (mm), max 10.000mm	

The crossing panels are packed and labeled separately (MIWO und PIR separated).